

Bradbury Pole Fitting and Assembly Instructions.

The Bradbury Pole is the most effective pole with rings. Due to its unique passing bracket the Bradbury Pole is suitable for long expanses and bay windows. All the Bradbury Pole brackets are adjustable in size and can be extended to account for any difference in measurements or wall inconsistencies.

Before commencing with the fitting please check that you have all the parts that you have ordered. You will also need in addition to the parts ordered the following tools.

1. A cross end screw driver.
2. A spirit level.
3. Drill
4. Metal Tape Measure

If you have ordered passing brackets then a drill bit and tapper are included to be used to connect the pole to the bracket. The required Hex keys are also included.

The ideal fitting position for the pole is around 10cm above the window and extended 15cm-30cm past the window on each side, depending on the size of the pole (these are only a guide and can be altered to suit personal needs and tastes).

Fitting a straight pole with normal brackets

1. Remove the back plate and cover from the wall end of the bracket by loosening the grub screw with the Hex key provided. Use the back plate and a tape measure to mark the screw holes on the wall at the desired fixing location and then drill the holes using a suitable bit size for the wall plugs. The ideal fixing location for the brackets at either end is 5cm-10cm from the end of the pole. On lengths over 150cm we recommend a bracket is fitted in the centre of the pole in addition to the end brackets and any additional passing brackets required.

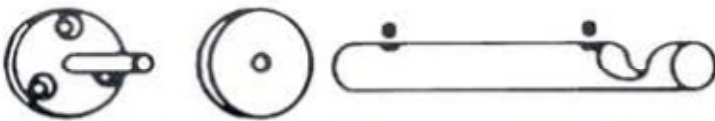

2. Hammer the wall plugs into each hole and then screw the bracket back plate into position. Replace the back plate cover and the bracket stem and tighten the grub screw.

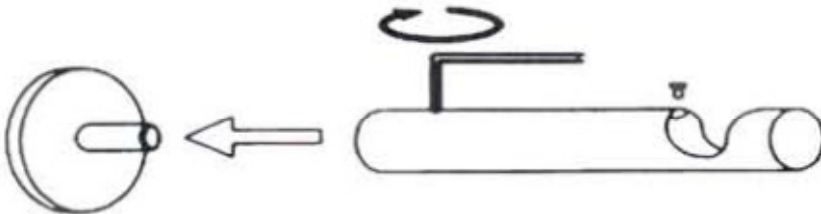

3. Slide all the rings onto the pole and then push on one finial into each end of the rod.
4. Place the pole in position onto the brackets ensuring that one ring on each end is positioned between the finial and the end bracket. If a centre bracket is being used make sure that an equal amount of rings are on each side of the centre bracket before securing the pole to the brackets.

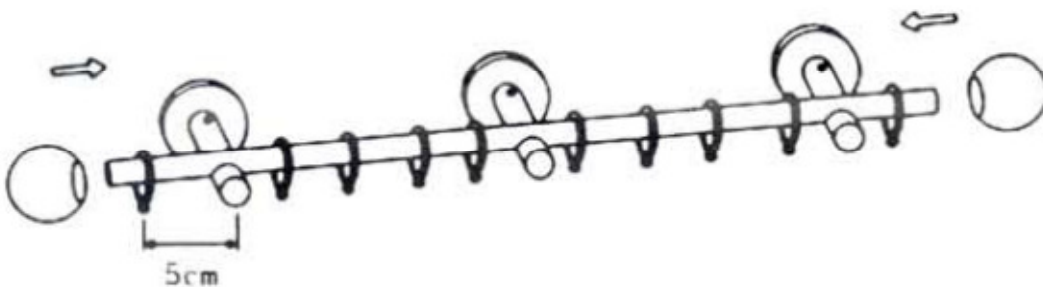

5. Once the pole is position on the brackets and in the correct place, tighten down the screw on the top of the bracket with a hex key provided until it is holding the pole in place.

Fitting a straight pole with passing brackets

1. Remove the back plate and cover from the wall end of the bracket by loosening the grub screw with the Hex key provided. Use the back plate and a tape measure to mark the screw holes on the wall at the desired fixing location and then drill the holes using a suitable bit size for the wall plugs. The brackets should be evenly spaced with the end brackets 5cm-10cm from the end of the pole.

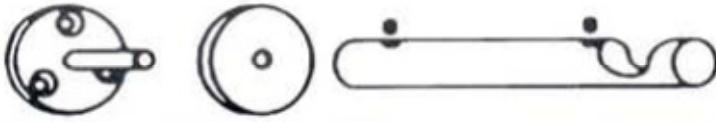

2. Hammer the wall plugs into each hole and then screw the bracket back plate into position. Replace the back plate cover and the bracket stem and tighten the grub screw. Ensure that the end and centre brackets are standard brackets and the brackets in between these are passing brackets.

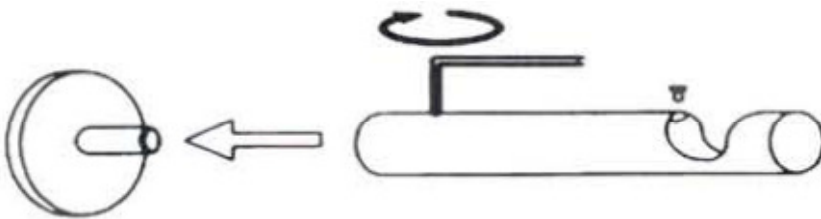

3. Place the pole in position onto the brackets ensuring that the pole is in the correct position. Using a pencil or pen mark the pole through the underneath of the passing brackets.
4. Once all the passing brackets have been marked in this fashion remove the pole from the brackets. Using the drill bit and tap provided, drill and tap the pole in the marked positions.
5. Slide all the rings onto the pole and then push on one finial into each end of the rod.
6. Place the pole in position on the brackets ensuring that one ring on each end is positioned between the finial and the end bracket. If a centre bracket is being used make sure that an equal amount of rings are on each side of the centre bracket before securing the pole to the brackets. Also ensure that the holes that have been drilled in the pole match up with the fixing holes on the adjustable passing brackets.
7. Once the pole is in position on the brackets and in the correct place, tighten down the screw on the top of the brackets with the hex key provided for the standard brackets (i.e. end and centre brackets) until it is holding the pole in place. Then using the screw provided screw up through the passing brackets fixing hole and into the tapped hole in the underneath of the pole.

Fitting a bay pole with passing brackets

1. Remove the back plate and cover from the wall end of the bracket by loosening the grub screw with the Hex key provided. Mark the screw holes on the wall at the desired fixing location and then drill the holes using a suitable bit size for the wall plugs. The brackets should be as evenly spaced as possible with the end brackets 5cm-10cm from the end of the pole. We also recommend that at least one bracket is fitted close to the bend to stabilise the pole. For more information on the fitting location for bay window brackets please see the diagram and instructions on the reverse of this page.

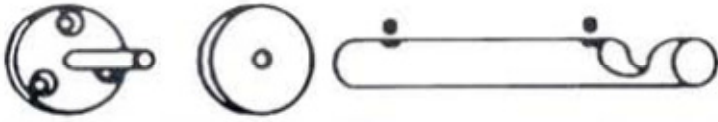

2. Hammer the wall plugs into each hole and then screw the bracket back plate into position. Replace the back plate cover and the bracket stem and tighten the grub screw. Ensure that the end and centre brackets are the standard brackets and the brackets in between are the passing brackets.

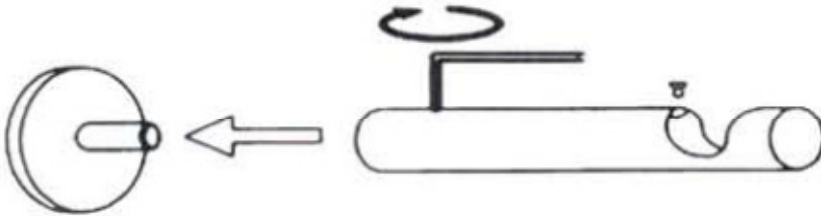

3. Place the pole in position onto the brackets ensuring that the pole is in the correct position. Using a pencil or pen mark the pole through the underneath of the passing brackets. All our brackets are adjustable to ensure that if the bay window is not totally level the brackets can be adjusted to ensure the pole can still be fitted. If the pole does not sit comfortably on the bracket loosen the grub screw in the bottom towards the front of the bracket with the Hex key provided and extend out until the pole is sitting nicely on the bracket.
4. Once all the passing brackets have been marked in this fashion remove the pole from the brackets. Using the drill bit and tap provided, drill and tap the pole in the marked positions.
5. Slide all the rings onto the pole and then push on one finial into each end of the pole.
6. Place the pole in position onto the brackets ensuring that one ring on each end is positioned between the finial and the end bracket. If a centre bracket is being used make sure that an equal amount of rings are on each side of the centre bracket before securing the pole to the brackets. Also ensure that the holes that have been drilled in the pole match up with the adjustable passing brackets.
7. Once the pole is position on the brackets and in the correct place, tighten down the screw on the top of the bracket with a hex key provided for the standard brackets (i.e. end and centre brackets) until it is holding the pole in place. Then using the screw provided screw up through the passing brackets and into the tapped hole in the pole.

Bracket Locations for Bay Windows.

The Bradbury Pole is designed to function superbly around bay windows. Please do not try to tweak, bend or otherwise force the pole yourself as you may damage the pole. All the Bradbury Pole brackets are adjustable in size and can be extended to account for slight difference in measurements or wall inconsistencies.

This diagram shows the optimum fitting Position for the brackets.

The location for bracket A should be between 5cm-10cm from the end of the pole.

Brackets B,C & E,F should be fitted on the straight Part of the pole as soon as it comes out of the bend.

Bracket B may not be required if the distance Between the start of the pole and the bend is less Than 60cm. This also applies for multi angled bays where the bracket can be placed in between the bends. Locate the remaining brackets on the straight sections of the pole evenly distributed around the bay. Brackets should be no more than 80cm apart. Make sure that Brackets at points A, D & G are standard adjustable brackets and that all the other brackets are adjustable passing brackets.

