

Silent Gliss®

3000 Cord Drawn Curtain Track Fitting Instructions

WARNING Parents should realise that children could accidentally strangle in window blind cords. Keep the cords out of the reach of children using one of these devices.



1. Clothes peg or bulldog clip



2. Cleat



3. Tie cord to itself



4. Cord tidy (Silent Gliss part No. 3799)

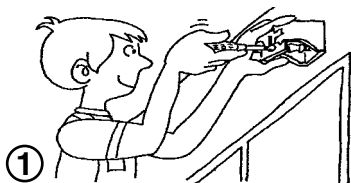

Firmly screw **3630** brackets to wall or ceiling. The two outside brackets should be located 12.5cm (5") in from the ends of track to provide stability. Remaining brackets should be equally spaced along track (approx. every 60cm/2').



Screw for wall or ceiling with universal bracket.

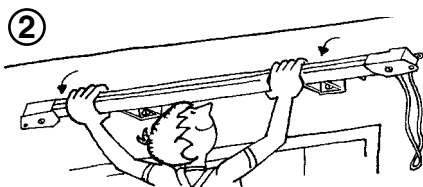

To install track simply locate as shown and press onto bracket in direction indicated.

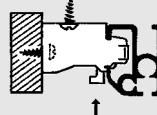

Removal: Push upwards and forwards.

3 EXTRA SUPPORT FOR CORD DROP

It is often desirable when the track is wall-fixed to make an extra fixing point over the end where the cord is pulled to give greater rigidity. A special tubular spacer and 1½" No. 8 screw are supplied with all systems pre-packed by Silent Gliss.

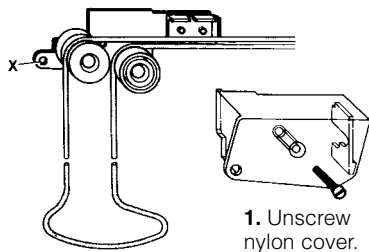

1. Unscrew nylon cover.

2. Drill hole in wall directly behind the 'X', insert screw through hole and spacer and screw firmly into position.

Replace nylon cover.

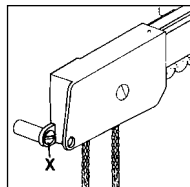

4 TRIMMING AND/OR ADJUSTING INSTRUCTIONS

If it is necessary to shorten your 3000 curtain track follow all instructions (1-8 overleaf) for pair stacking. For single stacking follow steps 1, 2, 4, 5, 6 & 7 only. To adjust the point where the curtains meet, follow steps 3 and 8 only. If cord drop is required at opposite ends to that supplied, simply follow step 3, pull cord through and the follow step 8.

P.T.O. These instructions are continued on reverse side.

Where the track is slotted to allow insertion of extra gliders without removing end pieces, remove springstops and insert gliders equally at each side, replace springstops.

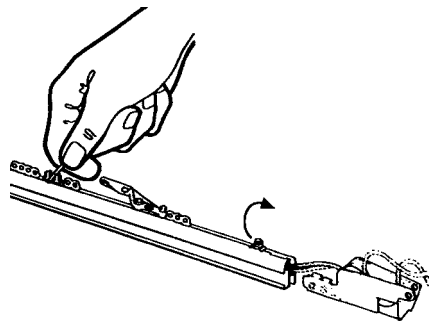

1. Place track face down on bench or floor and operate to take gliders to centre.
2. Slacken screws and pull end piece free.
3. Carefully prise out cord retaining pin from visible pilot runner.
4. Measure amount to be trimmed off exposed end of track and mark. Where the track is slotted the slot will no longer be usable. Discard springstops.
5. Pull cords through into glider channel and clear of cutting point.

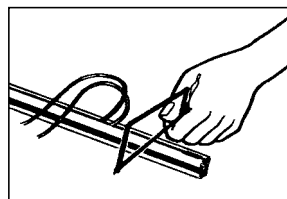
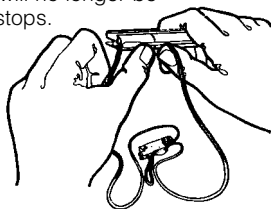

6. Cut track squarely with junior hacksaw and carefully de-burr with sharp knife or small file, paying particular attention to ends of cord channels.
7. Pull cords back into cord channels and check that they operate freely – replace end piece.
8. Move both pilot runners to the extreme ends of the track (i.e. in a fully open position) – hold cords in tension and press fully home cord retaining pin into pilot runner. (The pin must go through cord and if inserted correctly a 'click' will be heard.) Two gliders plus overlap or, if no overlap fitted, four gliders should remain between pilot runners.

Extras/Accessories (not supplied)

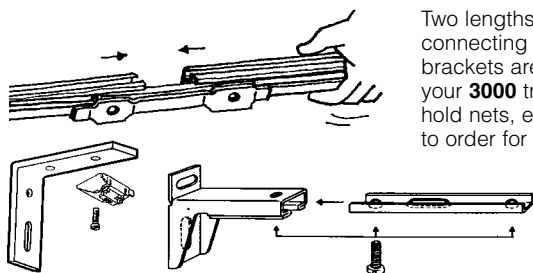

Two lengths of **3000** can be joined with a **3620** connecting bridge. Fixed or adjustable extension brackets are also available to enable you to use your **3000** track with a second Silent Gliss track to hold nets, etc. Ask your dealer. **3000** can be bent to order for bay windows, etc. from your stockist.

THIS TRACK CANNOT BE BENT AT HOME.

Silent Gliss Limited

Star Lane, Margate, Kent CT9 4EF, England
 Telephone: 01843 863571 Fax: 01843 864503
 E-mail: info@silentgliss.co.uk www.silentgliss.co.uk

